

	EQUIPAGGIAMENTI TECNICI LAVAGGIO	EIETTORE SCHIUMA PER SPAZZOLA BRUSH FOAM INJECTOR 21.0800.25	①	5
			Ⓜ	

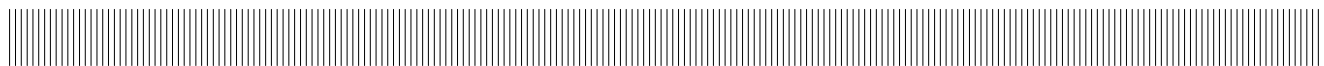

SPECIFICHE TECNICHE
SPECIFICATIONS

- PRESSIONE MASSIMA MAX PRESSURE	120 bar – 12 MPa (1750 psi)
- PORTATA MASSIMA MAX FLOW RATE	40 l/min (10.5 USG p.m.)
- DIAMETRO UGELLO NOZZLE Ø	Ø 2.5
- MATERIALE MATERIAL	INOX AISI 303

MISURE D'INGOMBRO
OVERALL DIMENSIONS

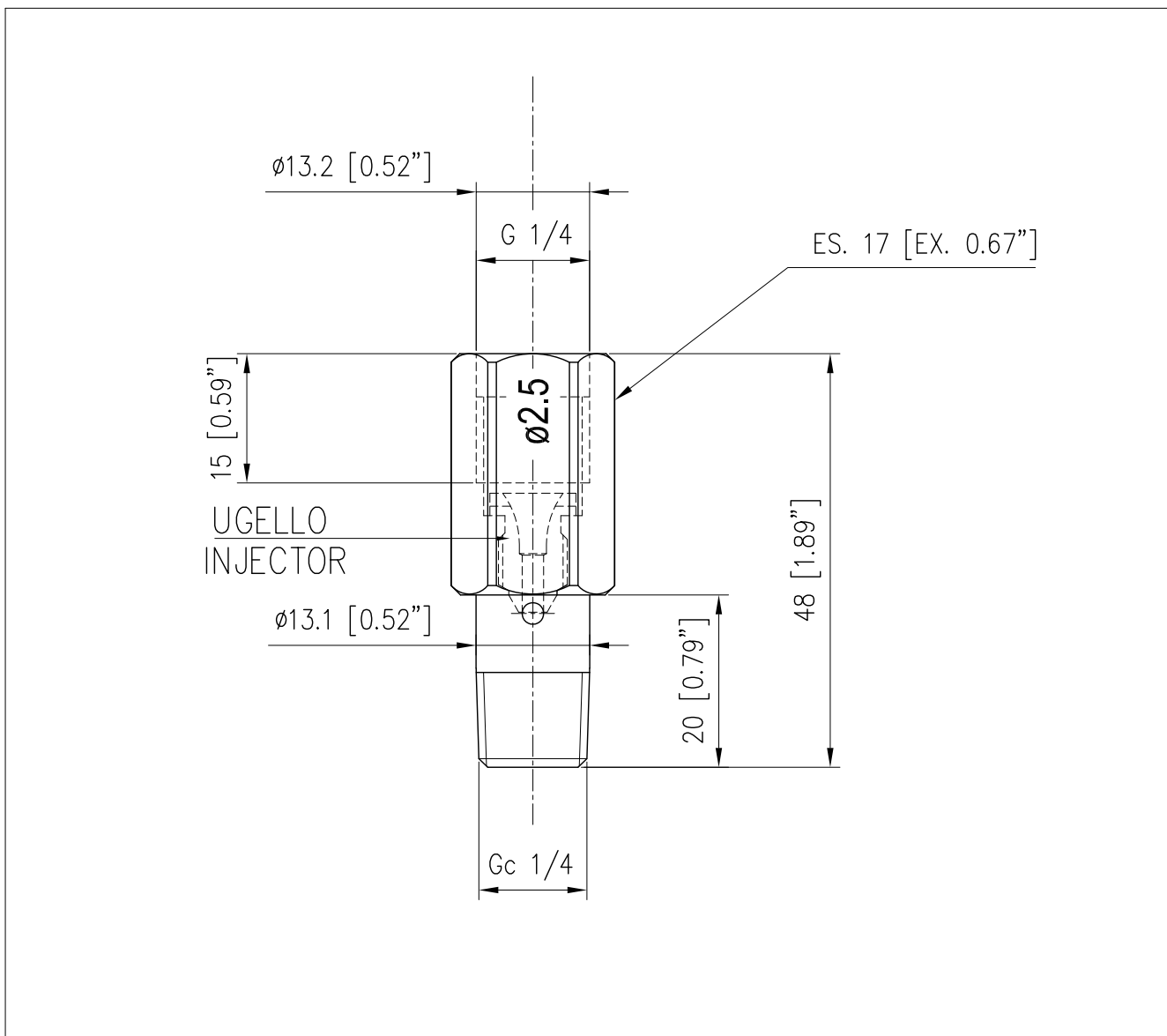

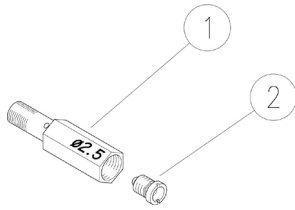

21.0800.25 Eiettore schiuma Gc1/4 M 2,5mm

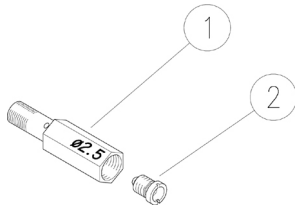

Pos.	Codice	Descrizione	Q.tà	K1	K2	K3	K4	
1	21.0801.51	Corpo eiettore Gc1/4 M inox	1					2
2	21.0009.51	Ugello M8x1 - 2,5 mm inox	1					10

21.0800.25 Foam Injector 1/4 Bspt M 2,5mm



Pos.	P/N	Description	Q.ty	K1	K2	K3	K4	
1	21.0801.51	Housing, Injector 1/4 Bspt M, Sst.	1					2
2	21.0009.51	Nozzle, M8x1 - 2,5 mm Sst.	1					10



P.A. S.p.A.

Via Milano, 13
42048 Rubiera, Reggio Emilia - Italy

Tel +39.0522.623611
Fax +39.0522.629600

info@pa-etl.it

www.pa-etl.it



COMPANY WITH QUALITY MANAGEMENT
SYSTEM CERTIFIED BY DNV
= ISO 9001 =