

	E T L	EQUIPAGGIAMENTI TECNICI LAVAGGIO	ATTACCO RAPIDO A GHIERA QUICK COUPLING WITH NUT AR1	① GB	5 01
					16/04/14

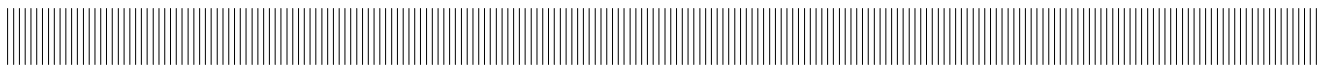

SPECIFICHE TECNICHE
SPECIFICATIONS

- PRESSIONE NOMINALE RATED PRESSURE	250 bar – 25 MPa (3650 psi)
- PRESSIONE CONSENTITA PERMISSIBLE PRESSURE	280 bar – 28 MPa (4050 psi)
- PORTATA MASSIMA MAX FLOW RATE	40 l/min (10.5 USG p.m.)
- TEMPERATURA MASSIMA MAX WORKING TEMPERATURE	160° C (320 °F)
- MATERIALE MATERIAL	GIRELLO IN PLASTICA ANTIURTO E GUARNIZIONI OR IN VITON. BODY IN SHOCKPROOF PLASTIC AND VITON O-RING

MISURE D'INGOMBRO
OVERALL DIMENSIONS

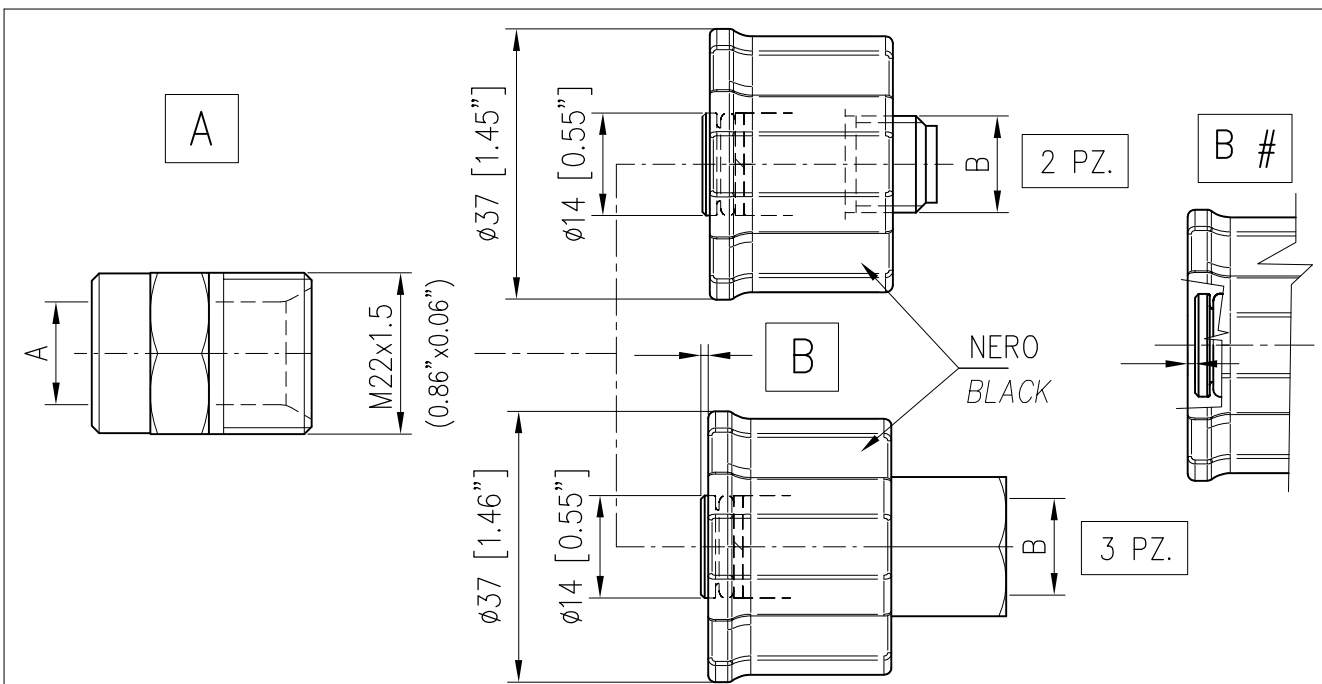

CODICE CODE	A	CODICE CODE	B	CODICE CODE	B # PERNO GIREVOLE ROTATING PIN
26.0002.31	G1/4F	2 PZ.	26.0150.05	2 PZ.	26.0150.31
26.0005.31	M22x1.5 – Di 14		26.0150.20		26.0250.21
26.0029.31	G1/8F		26.0150.30		26.0250.31
26.0030.31	G3/8M	3 PZ.	26.0150.40	3 PZ.	26.0250.41
26.0031.31	G3/8F		26.0250.05		26.0250.51
26.0032.31	G1/2M		26.0250.20		26.0250.61
26.0033.31	G1/2F		26.0250.30		26.0250.71
26.0041.31	M21x1.5 – Di 14		26.0250.40		
26.0051.31	G1/4M		26.0250.50		
			26.0250.60		
		26.0250.70			