

25.1246.20 RR-TF20 Dr.ci.nozzle,rotat.,sst 1/2F Bsp

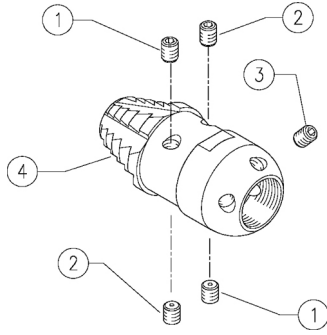

25.1246.30 RR-TF 30 Dr.ci.nozzle,rotat. sst 1/2F Bsp

		K1 K2 K3 K4				
1	25.1257.51R Nozzle, 070 - M6 Sst. (1)	2				10
1	25.1251.51R Nozzle, 025 -M6 Sst. (2)	2				10
2	25.1251.51R Nozzle, 025 -M6 Sst. (1)	2				10
2	25.1250.51R Nozzle, 015 M6 Sst. (2)	2				10
3	25.1251.51R Nozzle, 025 -M6 Sst. (1)	6				10
3	25.1250.51R Nozzle, 015 M6 Sst. (2)	6				10
4	25.1246.00 RR-TF00 Rotat. Drain-CI.Nozzle G1/2F Sst.	1				1

(1) 25.1246.30 (2) 25.1246.20