

EQUIPAGGIAMENTI
TECNICI
LAVAGGIO

25.0450.00
SAND BLASTING HEAD TS12

GB

4

23/08/17

10.9115.00

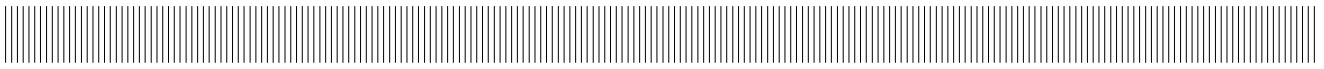

SETTING INSTRUCTIONS

IN ORDER TO GUARANTEE THE BEST PERFORMANCE AND AVOID EARLY WEAR AND DAMAGE OF PARTS, PLEASE MAKE SURE TO FOLLOW THESE INSTRUCTIONS.

– In case you wish to vary the quantity of sand sucked, set the position of the high pressure nozzle "A" according to the maximum and minimum distance as shown in fig.1.

Screw the fitting "C" (fig2) up to the high pressure nozzle "A" to the minimum distance of 35 mm. Upon gun opening, gradually unscrew till obtaining in the sand feedline duct the desired depression; this depression can be controlled by means of a vacuumeter or by simply covering the duct inlet with your hand.

– The jet angle of the high pressure nozzle "A" must be max. 15°.

– The jet of the high pressure nozzle "A" must be PERFECTLY ALIGNED with the rectangular hole of the insert "B" as shown in fig. 2.

To make this operation easy, after assembling the nozzle "A" we suggest to mark the hexagonal fitting "C" with a dot just next to the jet position.

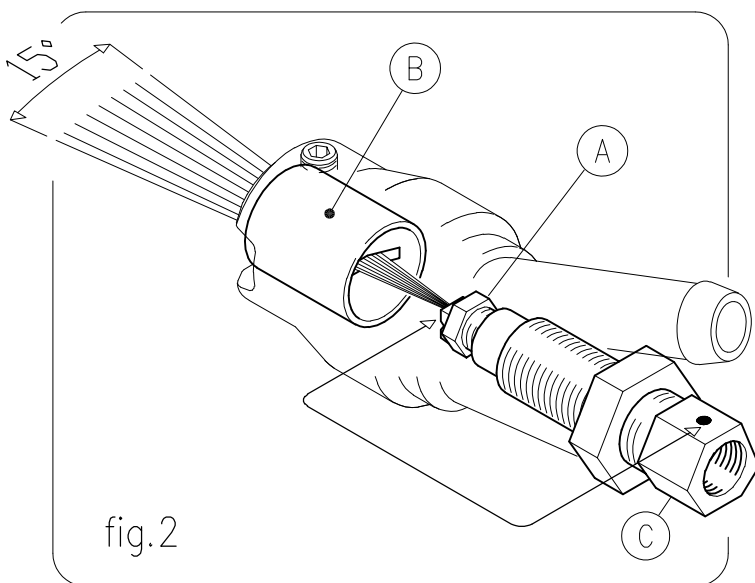
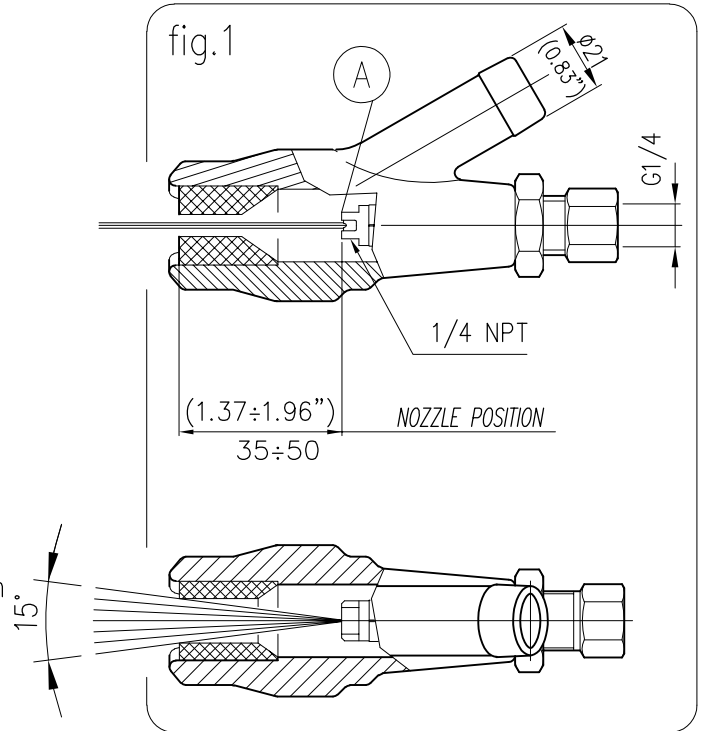

–The use of "A" nozzles is compulsory when the pressure is over 200 bar – 20 MPa (3000 PSI). In order for the sand blaster to perform at best, it is strongly recommended to use the special nozzles code: 16.1415.XX supplied by PA.

WARNING: Using a regular nozzle NOT suitable to operate at high pressure will produce premature wear and will cause damages on the internal section of the sand blaster.